

Main Specifications	Other Specifications
<p>▼ Size 3" (76mm)</p> <p>▼ Pressure connection Material: SS304 FKMO-ring sealed 1/4" NPT 1/4" PT 1/2" PT Other thread type available upon request</p> <p>▼ Pressure range Min.: 0.1 bar Max.: 1000 bar</p> <p>▼ Applicable fluid Liquid and gas that compatible with SS304</p> <p>▼ Ambient temperature -30°C to +80°C</p> <p>▼ Fluid temperature +80°C</p> <p>▼ Ambient humidity 0~80% R.H.</p> <p>▼ Atmospheric pressure 860...1060 mbar</p> <p>▼ Temperature error Standard temp.: 22°C max. error: ±0.5% F.S (0~50°C)</p> <p>▼ Protection level IP65</p> <p>▼ Test data Vibration test: 0~300Hz Impact test: ≤ 10 x 9.81ms⁻²</p>	<p>▼ Ring Stainless steel</p> <p>▼ Case SS 304</p> <p>▼ Screen display 4-digit LCD</p> <p>▼ Screen size 30 x 20 mm</p> <p>▼ Refresh rate 2 times/sec</p> <p>▼ Pressure unit MPa, bar, psi, kPa, mH₂O</p> <p>▼ Resolution 0.001</p> <p>▼ Measuring elements High-tech silicon chip SS 316L diaphragm</p> <p>▼ Accuracy ±0.1% F.S. (min.) ±0.25% F.S. (standard) ±0.5% F.S. (max.)</p> <p>▼ Stability ±0.25% F.S./year</p> <p>▼ Operating pressure Overpressure: 1.5* full scale Burst pressure: 3* full scale</p> <p>▼ Compensated temperature -10°C to 80°C</p> <p>▼ Power supply 3.6V battery 2400mAh / 8~28VDC external power supply</p> <p>▼ Insulation resistance 100MΩ, 50V</p> <p>▼ Battery life One year (disposable battery)</p> <p>▼ Weight 420g</p>

Intelligent Pressure Gauge

Model: APM4760

Introduction

APM4760 Intelligent digital pressure gauge adopts LCD display and high stability pressure sensors. It can apply to measure and display pressure value on-site.

With high-tech digitalized temperature compensation and nonlinear correction technology, APM4760 can ensure its pressure measurement with high accuracy and stability. Its features include compact appearance, reliable measurement and excellent performance, which makes it an ideal choice for measure and display fluid pressure.



Features

- OEM service
- SS 304 case & connection
- Analog output 4-20mA / digital output RS485 available
- Maximum value / minimum value / percentage display mode
- Battery / external power supply available
- Max accuracy 0.1%
- Switchable pressure units

Due to the variety of customization, the picture is only for reference, please confirm the actual item with our sales. (If there is any change on specification, please take the latest version as standard.)

Dimension

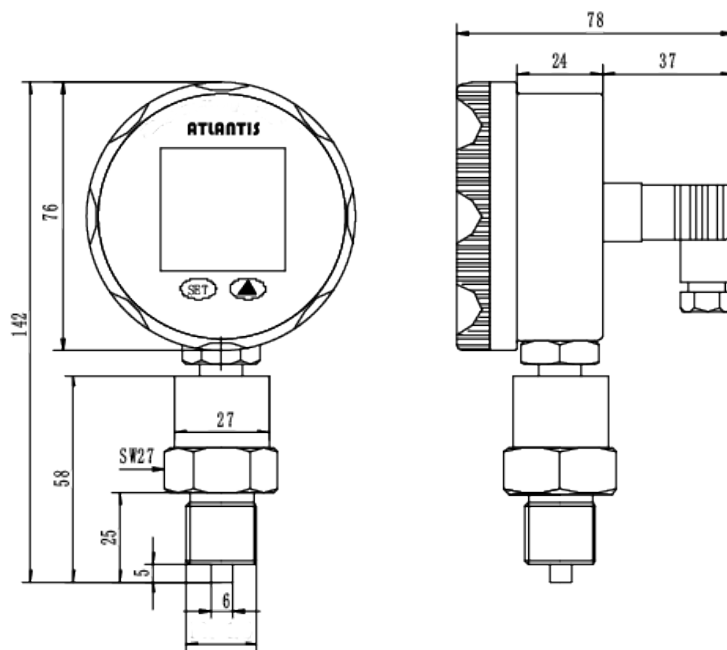

Unit: mm

How to order

APM4760		Intelligent pressure gauge		
Code	Pressure range			
Custom	-1...0...0.1 to 1000 bar			
Code	Power supply			
N	Battery			
PSD	External power supply			
Code	Pressure connection			
2N	1/4" NPT			
2P	1/4" PT			
4P	1/2" PT			
O	Others (please specify)			
Code	Other requests			
/A	Third party notarized document			
/B	Inspection report			
/C	Tag			
/D	4-20mA signal output			
/E	RS485 digital output			
APM4760	0...10bar	N	2P	Order example: APM4760 - 0...10bar - N - 2P